



**JOBES
HENDERSON &
ASSOCIATES INC.**

CIVIL ENGINEERING & LAND SURVEYING

LEGAL DESCRIPTION OF 0.064 ACRE PARCEL

Situated in the Township of Claridon, County of Geauga, and State of Ohio, and known as being part of Lot 2 of said Township, Section 15, East Survey, and being a part of that tract as conveyed to Geauga County Park District by deed of record in Volume 1442, Page 709, all references being to those of record in the Records of Deeds, Geauga County, Ohio, said parcel being more particularly described as follows:

Commencing at a Geauga County monument found, a 5/8" iron pin used by Bill Loetz as 4-corner Township point (Townships Claridon, Huntsburg, Middlefield and Burton), see plat copy on file at the Geauga County Engineer's Office;

thence **North 04°23'05" East, 63.06 feet** to a point in the centerline of Durkee Road (60' R/W);

thence along said centerline, **North 56°51'20" East, 751.78 feet** to a point in the center of pavement of Old State Road (60'R/W), also known as State Route 608;

thence along said center of pavement the following seven (7) courses and distances;

North 50°53'05" West, 110.00 feet to a point;

northwesterly along a curve to the left (radius=1630.71', delta=8°46'00", length=249.51'), a chord bearing and distance of **North 55°16'06" West, 249.27 feet** to a point;

North 59°39'06" West, 12.09 feet to a point;

northwesterly along a curve to the right (radius=698.64', delta=20°17'16", length=247.38'), a chord bearing and distance of **North 49°30'28" West, 246.09 feet** to a point;

North 39°21'49" West, 400.78 feet to a point;

northwesterly along a curve to the right (radius=3916.79', delta=5°06'59", length=349.77'), a chord bearing and distance of **North 36°48'20" West, 349.65 feet** to a point; and...

North 34°14'50" West, 466.51 feet to a point marking the southwesterly corner of that 2.092 acre tract as conveyed to Edgar B. and Loretta C. Boatwright by deed of record in Volume 927, Page 1261;

CLA 00006
LEGAL DESCRIPTION OF 0.064 ACRE PARCEL

Page 2

thence along the westerly line of said Boatwright tract and the centerline of Old State Road the following two (2) courses and distances;

North 34°14'37" West, 188.26 feet to a point, said point being referenced, **South 55°45'23" West, 50.29 feet** from a 5/8" rebar set with I.D. cap; and...

North 14°59'20" West, 205.86 feet to a point marking the southwesterly corner of that 1.000 acre tract as conveyed to Clifford E. and Gwendolyn H. Baker by deed of record in Volume 582, Page 638;

thence along the southerly line of said Baker tract, **South 86°39'32" East, 305.60 feet** to a 5/8" rebar found marking the southeasterly corner of said Baker tract and being the **Point of Beginning** for the 0.064 acre parcel herein to be described, passing a 5/8" rebar set with I.D. cap at 34.00 feet;

thence along the easterly line of said Baker tract, **North 09°53'48" West, 140.13 feet** to a 3/4" iron pipe found marking the northeasterly corner of said Baker tract;

thence across said Geauga County Park District tract the following three (3) courses and distances;

South 85°37'01" East, 20.63 feet to a 5/8" rebar set with I.D. cap;

South 09°53'48" East, 139.72 feet to a 5/8" rebar set with I.D. cap; and...

North 86°43'47" West, 20.54 feet to the **Point of Beginning** and containing **0.064 acres**, more or less, according to a survey made by Steven L. Mullaney, P.S. 7900 of Jobes Henderson & Associates, Inc. during April of 2005.

The bearings in the above description are based on an assumed meridian and are used to denote angles only.

All iron pins set are rebar, 5/8" in diameter by 30" in length with red surveyors identification caps marked "J&H #7900".

Subject to all valid and existing easements, restrictions and conditions of record.

~~SURVEY PLAT & LEGAL DESCRIPTION
APPROVED PER R.C. 315.251
OFFICE OF THE
GEAUGA COUNTY ENGINEER~~



SURVEY PLAT & LEGAL DESCRIPTION
APPROVED PER R.C. 315.251
R.S. *5/18/05*
OFFICE OF THE *Revised*
GEAUGA COUNTY ENGINEER
Steven L. Mullaney
Steven L. Mullaney, P.S.
Reg. Surveyor No. 7900



**JOBES
HENDERSON &
ASSOCIATES INC.**
CIVIL ENGINEERING & LAND SURVEYING

LEGAL DESCRIPTION OF 1.064 ACRE PARCEL

Situated in the Township of Claridon, County of Geauga, and State of Ohio, and known as being part of Lot 2 of said Township, Section 15, East Survey, and being a combination of that 1.000 acre tract as conveyed to Clifford E. and Gwendolyn H. Baker by deed of record in Volume 582, Page 638 and a 0.064 acre parcel from that tract as conveyed to Geauga County Park District by deed of record in Volume 1442, Page 709, all references being to those of record in the Records of Deeds, Geauga County, Ohio, said parcel being more particularly described as follows:

Commencing at a Geauga County monument found, a 5/8" iron pin used by Bill Loetz as 4-corner Township point (Townships Claridon, Huntsburg, Middlefield and Burton), see plat copy on file at the Geauga County Engineer's Office;

thence **North 04°23'05" East, 63.06 feet** to a point in the centerline of Durkee Road (60' R/W);

thence along said centerline, **North 56°51'20" East, 751.78 feet** to a point in the center of pavement of Old State Road (60'R/W), also known as State Route 608;

thence along said center of pavement the following seven (7) courses and distances;

North 50°53'05" West, 110.00 feet to a point;

northwesterly along a curve to the left (radius=1630.71', delta=8°46'00", length=249.51'), a chord bearing and distance of **North 55°16'06" West, 249.27 feet** to a point;

North 59°39'06" West, 12.09 feet to a point;

northwesterly along a curve to the right (radius=698.64', delta=20°17'16", length=247.38'), a chord bearing and distance of **North 49°30'28" West, 246.09 feet** to a point;

North 39°21'49" West, 400.78 feet to a point;

northwesterly along a curve to the right (radius=3916.79', delta=5°06'59", length=349.77'), a chord bearing and distance of **North 36°48'20" West, 349.65 feet** to a point; and...

North 34°14'50" West, 466.51 feet to a point marking the southwesterly corner of that 2.092 acre tract as conveyed to Edgar B. and Loretta C. Boatwright by deed of record in Volume 927, Page 1261;

CLA00006
LEGAL DESCRIPTION OF 1.064 ACRE PARCEL

Page 2

thence along the westerly line of said Boatwright tract and the centerline of Old State Road the following two (2) courses and distances;

North 34°14'37" West, 188.26 feet to a point, said point being referenced, **South 55°45'23" West, 50.29 feet** from a 5/8" rebar set with I.D. cap; and...

North 14°59'20" West, 205.86 feet to a point marking the southwesterly corner of said Baker tract and being the **Point of Beginning** for the 1.064 acre parcel herein to be described;

thence along the westerly line of said Baker tract, **North 14°59'20" West, 149.84 feet** to a point marking the northwesterly corner of said Baker tract, said point also being in the southerly line of that 58 acre tract as conveyed to Frederick E. and Sherrill Hatch by deed of record in Volume 1267, Page 464;

thence along the northerly line of said Baker tract and the southerly line of said Hatch tract, **South 85°37'01" East, 341.32 feet** to a 5/8" rebar set with I.D. cap, passing a 3/4" iron pipe found at 33.76 feet and a 3/4" iron pipe found marking the northeasterly corner of said Baker tract at 320.69 feet;

thence across said Geauga County Park District tract the following two (2) courses and distances;

South 09°53'48" East, 139.72 feet to a 5/8" rebar set with I.D. cap; and...

North 86°43'47" West, 20.54 feet to a 5/8" rebar found marking the southeasterly corner of said Baker tract, the same being the northeasterly corner of that 2.092 acre tract as conveyed to Edgar B. and Loretta C. Boatwright by deed of record in Volume 927, Page 1261;

thence along the southerly line of said Baker tract and the northerly line of said Boatwright tract, **North 86°39'32" West, 305.60 feet total**, passing a 5/8" rebar set with I.D. cap at 271.60 feet, to the **Point of Beginning** and containing **1.064 acres**, more or less, according to a survey made by Steven L. Mullaney, P.S. 7900 of Jobes Henderson & Associates, Inc. during April of 2005.

The bearings in the above description are based on an assumed meridian and are used to denote angles only.

All iron pins set are rebar, 5/8" in diameter by 30" in length with red surveyors identification caps marked "J&H #7900".

Subject to all valid and existing easements, restrictions and conditions of record.

May 9, 2005

S:\04\04-086\legals\04-086-1.064ACRES

SURVEY PLAT & LEGAL DESCRIPTION
APPROVED PER R.C. 315.251

R.S.

5/18/05
Revised

OFFICE OF THE
GEAUGA COUNTY ENGINEER

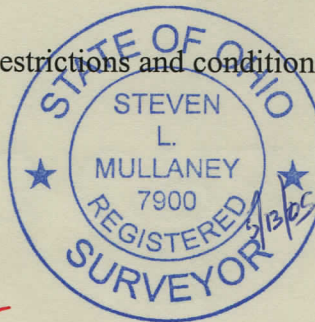

Steven L. Mullaney
Steven L. Mullaney, P.S.
Reg. Surveyor No. 7900